

**SBI**

**Modular Ltd.**

**(888) 307-5470**

**www.sbimodular.com**



## 11' x 16' Self-Contained Wheeled Lavatory

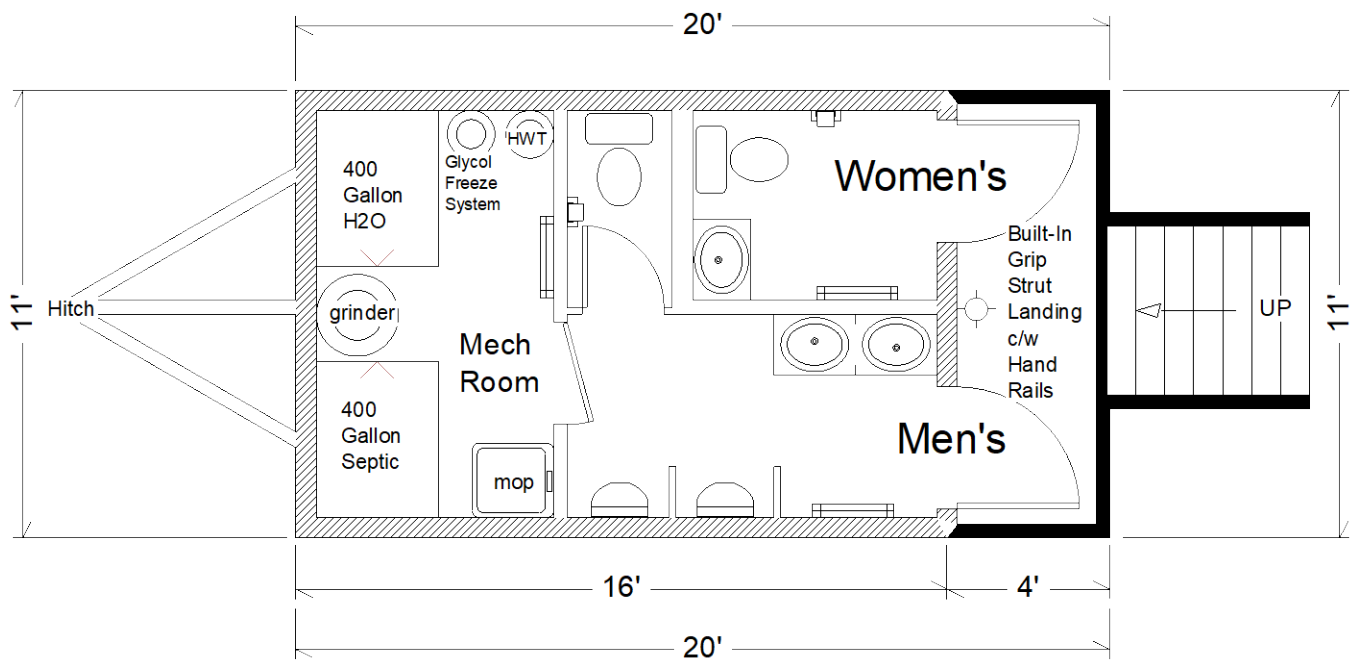

**SBI Built Industrial Grade**







# 11' x 16' Self-Contained Wheeled Lavatory

- Tandem 8,000 lbs Axles c/w Electric Brakes, 5 only, Spring Loaded Jacks, Weight: 12,350 lbs.,
  - 60 amp 120/240, single phase, Electric Heat, Heavy Duty Industrial Grinder Pump
  - Automated Glycol Freeze Protection System c/w Alarm upon Heat/Power Loss
  - Built-In Grip Strut Landing c/w Handrails, Sliding Steps & Detachable Handrails
    - 2"x6" Exterior Walls, (FRP) Water Resistant Interior Walls throughout
    - Fixtures: (2) toilets, (2) urinals, (3) sinks (1) mop sink
    - Stainless Steel Sinks/Vanities c/w Metered Faucets
    - 400 Gallon H2O Storage & 400 Gallon Septic Tanks



Glycol Freeze Protection System    Heavy Duty Grinder Pump



**SBI**  
**Modular Ltd.**  
**(888) 307-5470**  
**[www.sbimodular.com](http://www.sbimodular.com)**

Contact

Information:

**Barry Richmond**  
**Sales Representative**

(403) 371-4280

[b.richmond@sbimodular.com](mailto:b.richmond@sbimodular.com)

# OHS Codes for Toilets & Washing Facilities Guide



## Occupational Health and Safety Code

### Quick Reference Guide

#### OHS Code: Part 24 - Toilets and Washing Facilities Requirements

##### Section 357, Toilet facilities:

This section specifies the minimum number of toilets to be provided at a work site for members of each sex, based on the number of workers of that sex at the work site. Rules by which toilets are substituted with urinals are also described. A work site may have only one toilet facility for the use of both sexes if:

- (1) The total number of workers at the work site is never more than 10, and
- (2) The door to the toilet facility can be locked from the inside.
- (3) If 3 or more toilets are required for men, employer may substitute not more than 2/3's of the toilets with urinals
- (4) If 2 toilets are required for men, an employer may substitute one of them with a urinal.

Number of Workers of each Sex	Minimum Number of Toilets for That Sex
1-10	1
11-25	2
26-50	3
51-75	4
76-100	5
> 100	6 plus 1 for each additional 30 workers of the sex in excess of 100

**\*Provided information is intended for 'reference' purposes only. For more detailed code information please contact Alberta Labour - Occupational Health and Safety Toll-free in Alberta: 1-866-415-8690 or [www.work.alberta](http://www.work.alberta)**

**SBI** Built... *Designed and Manufactured in Alberta*

